

# MEGA<sup>®</sup>LITE

PIELITE  
MULTIBEAM



## USER MANUAL

### Table of Contents

Safety Information	2
What's Included	2
Specifications	3
Main Power Connection	4
DMX Connection	4
Display Settings	5
DMX Profile	7
Size And Weight	8
Segment	9
Installation	9
Warranty	11
Customer Service	12

**Check that the unit has not been damaged during transport.**



Read all cautions and warnings  
prior to operation of this  
equipment

### Protection Against Fire



1. Maintain a minimum of 1 foot distance from any type of flame.
2. Fixture is designed for indoor use.
3. Do not install the unit too close to a heat source.
4. Make sure cables are properly secured.
5. Maximum surface operating temperature: 130°.
6. Make sure fixture lens are not pointing towards the sun or direct light input.

### Protection Against Electrical Fire

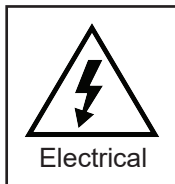

1. Disconnect power before servicing.
2. For connection to main power supply, proceed to page 4.
3. The power supply must be earthed (electronically grounded).
4. This fixture must not be left on for long periods of time.

### Protection Against Mechanical Hazards

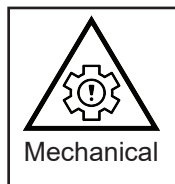

1. Use secondary safety chain when hanging unit.
2. Use quality clamps or bolts when positioning unit.
3. Do not open unit while it is on. Risk of electrical shock.

### What is Included

1pc Pielite Fixture  
1pc Power Cable  
1pc Quick Release Clamp Mount  
2pc Quick Release Joining Mount  
1pc User Manual

# Specifications

---

## Part Numbers

---

### Fixture ID

4150-Pielite Multibeam

## Mechanical Specifications

---

<b>Housing:</b>	Metal
<b>Mounting System:</b>	Quick Release Clamp Mounts, Multiple Fixture Quick Release Joining Mounts
<b>Power Connection:</b>	Seetronics SAC3MPX Input & SACFPX output (Nema 5-15 to SAC3FX-67 cable included)
<b>Signal Connection:</b>	3 and 5 Pin XLR In and Out
<b>Lens:</b>	4.5°
<b>Weight:</b>	15 lb 14oz
<b>Size:</b>	21" X 11.33" X 5.25"

## Electrical Specifications

---

<b>Light Source:</b>	7 X 60W RGBW
<b>Lumens:</b>	792Lm each LED
<b>Color Temp White:</b>	7227K (white Emitter Only)
<b>CRI: (Cool White)</b>	73
<b>Signal Support:</b>	DMX 512, RDM
<b>Power:</b>	Electronic 90-264V AC 50/60
<b>Power Consumption:</b>	537 Watts 4.69 Amps @110V

## Control & Programming

---

<b>Protocol:</b>	DMX 512, RDM
<b>DMX 4 Modes:</b>	<b>4 Channel Mode:</b> Red, Green, Blue, White <b>10 Channel Mode:</b> Dimmer, R, G, B, W, Strobe, Shutter Macro, Shutter Macro Speed, Color Macro, Color Macro Speed <b>28 Channel Mode:</b> Red, Green, Blue, White X 7 <b>38 Channel Mode:</b> Dimmer, R, G, B, W, Strobe, Shutter Macro, Shutter Macro Speed, Color Macro, Color Macro Speed
<b>RDM Parameters:</b>	Fixture Label DMX Start Channel Address Channel Mode Set
<b>Operating Mode:</b>	DMX, Auto and Manual Settings Via Display

## Main Power Connection

### Caution!

1. Do not connect fixture to a dimmer system.
2. This unit must be earthed. (Electronically grounded)
3. Replace fuse only with the specified type and rating. (F6 250V)
4. This device is equipped with auto switching power supply that will allow the fixture to work from 90-264V AC 50/60Hz
5. Power Link max 3 units at 110V and 6 units at 220V

Cable USA	Cable EU	110V	220V
Black	Brown	Live	Live
White	Light Blue	Neutral	Live
Green	Yellow / Green	Ground	Ground

## DMX-512 Connection

The fixture is equipped with 5 pin XLR Sockets for DMX input and output connection. The sockets are wired in parallel. Only use a shielded twisted pair cable designed for RS-485 and 5 pin XLR plugs and connectors in order to connect the controller with the fixture or the fixture with another.

### DMX - Input

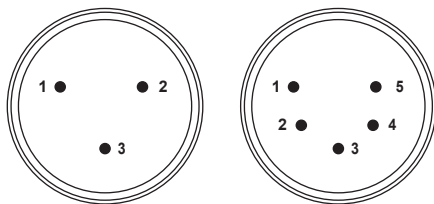

1. Shield (Grd)
2. Signal (-)
3. Signal (+)
4. N/A
5. N/A

### DMX - Output

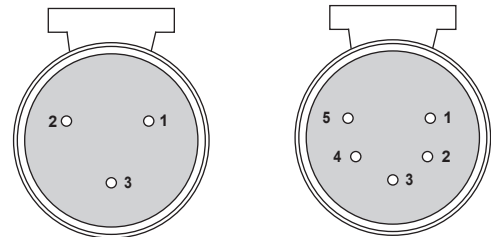

### Caution!

On the last fixture the DMX signal needs to be terminated with a terminator. Pre-manufactured terminator are available for purchase from your Mega-Lite dealer item #P-DMX-T.



# Display Control

The control board on the fixture base is your interface to access and control all the functions on the unit. It's LCD display gives you a code view of the options and functions. The following will explain each function.

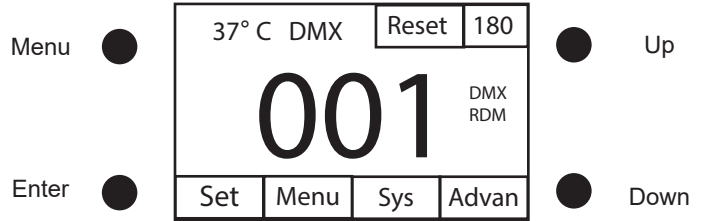

37° C DMX	Reset	180
001	DMX RDM	
Set	Menu	Sys
Advan		

**Addressing:** Use the Up/Down buttons to select the large 3 digit numbers. Press Enter use the Up/Down buttons to select the appropriate start channel. Start channel must match the DMX controller start channel.

37° C DMX	Reset	180
001	DMX RDM	
Set	Menu	Sys
Advan		

**Settings:** Settings menu allows you to customize the fixture operational functions

▶ Set	
DMX Addr	001
Run Mode	DMX
Channel Mode	10CH
No DMX Signal	Keep
Display	On
Display Lock	Off

**DMX Address:** Allows you to set the fixtures start address to match DMX Control

**Run Mode:** Allows you to select operational mode from DMX, Auto ,Auto 2, Auto3, User and Manual options

**Mode Set:** Options for Playback Auto Program

**Channel Mode:** Will give you the option of operational DMX profile use.

- 04 CH:** Red, Green, Blue, White
- 10 CH:** Dimmer, R,G,B,W, Strobe, Shutter Macro, Shutter Macro Speed, Color Macro, Color Macro Speed
- 28 CH:** R,G,B,W X 7
- 38 CH:** Dimmer, R,G,B,W, Strobe, Shutter Macro, Shutter Macro Speed, Color Macro, Color Macro Speed, R,G,B,W X 7,

**No DMX Signal:** If DMX Signal is lost=

- Keep** option will hold the last dmx command.
- Clear** will turn all channels to off position

**Display:**

- On:** option will turn display off after no use for 45 seconds
- Off:** will leave display on

**Display Lock:**

- On:** Requires Password to access Display
- Off:** No password required
- Password** to unlock is Press and hold Back and Enter

**DimCurve:** Dimming Curve Options

S Curve, Biquadrate, Square Root, Cube Root, Fourth Root, Logarithm, Linear, Square, Curve

37° C DMX Reset 180

001

DMX  
RDM

Set
Menu
Sys
Advan

**Manual:** Gives you operational control over the fixture via display

▶ Menu

Dimmer	255
Red	127
Green	000
Blue	255
White	127
Shutter	000

**Manual:** Select the Channel you wish to adjust. Use the up/down button to select the function setting from 0-255. Channels to adjust are:

Dimmer	Shutter
Red	Shutter Macro
Green	Shutter Speed
Blue	Color Effect
White	Color Speed

Reset 180

001

DMX  
RDM

Set
Menu
Sys
Advan

**System:** Allows you to see the fixtures operational status.

▶ System

Vers	BT6L-H230629
Start time	0000Min
Use time	00001Hour
Dmx Monitor	▶
Test	

**System:** Fixtures bio's

vers:	Software version
start time:	
use time:	Time fixture has been powered on in Hours
DMX Monitor:	Channel view of the DMX Values being used at the time
test:	internal manufactures setting (password required)

Reset 180

001

DMX  
RDM

Set
Menu
Sys
Advan

**Advance:** Advance Factory Settings, please reach out to customer service for more information.

Fine adj:	Password protected for fixture fine adjustment
Language:	Choose between English and Chinese
Factory Settings:	Password Protected
Security:	Password Protected
Recover Settings:	Factory reset to original settings

Reset 180

001

DMX  
RDM

Set
Menu
Sys
Advan

**180:** Invert Display 180degrees.

# DMX Profile

Pielite Multibeam							
4 Channel Mode	10 Channel Mode	28 Channel Mode	38 Channel Mode	Function	Description	Value	Init Value
	1		1	Dimmer	Dimmer Off to Full	0-255	255
1	2		2	LED Intensity	Red LED Intensity	0-255	255
2	3		3	LED Intensity	Green LED Intensity	0-255	255
3	4		4	LED Intensity	Blue LED Intensity	0-255	255
4	5		5	LED Intensity	White LED Intensity	0-255	255
					No Function	0-9	
	6		6	Strobe (Requires R,G,B,W LED Intensity)	Strobe (slow to fast)	10-99	
					Pulse Strobe (slow to fast)	100-149	0
					Random Strobe All (slow to fast)	150-199	
					Random Strobe Each Segment (slow to fast)	200-255	
					No Function	0-9	
					Macro 1	10-49	
					Macro 2	50-99	
					Macro 3	100-109	
					Macro 4	110-119	
					Macro 5	120-129	0
					Macro 6	130-139	
	7		7	Shutter Macro (Requires LED Intensity)	Macro 7	140-149	
					Macro 8	150-159	
					Macro 9	160-169	
					Macro 10	170-179	
					Macro 11	180-189	
					Macro 12	190-199	
					Macro 13	200-209	
					Macro 14	210-219	
					Macro 15	220-227	
					Macro 16	228-255	
	8		8	Macro Speed	Macro Speed (slow to fast)	0-255	0
					No Function	0-9	
					Macro 1	10-49	
					Macro 2	50-99	
					Macro 3	100-109	
					Macro 4	110-119	
					Macro 5	120-129	0
					Macro 6	130-139	
	9		9	Color Effect	Macro 7	140-149	
					Macro 8	150-159	
					Macro 9	160-169	
					Macro 10	170-179	
					Macro 11	180-189	
					Macro 12	190-199	
					Macro 13	200-209	
					Macro 14	210-219	
					Macro 15	220-227	
					Macro 16	228-255	
	10		10	Color Effect Speed	Color Effect Speed (slow to fast)	0-255	0
		1	11	Segment 1	Segment 1 Red	0-255	0
		2	12	Segment 1	Segment 1 Green	0-255	0
		3	13	Segment 1	Segment 1 Blue	0-255	0
		4	14	Segment 1	Segment 1 White	0-255	0
		" "	" "	" "	" "	" "	" "
		25	35	Segment 7	Segment 7 Red	0-255	0
		26	36	Segment 7	Segment 7 Green	0-255	0
		27	37	Segment 7	Segment 7 Blue	0-255	0
		28	38	Segment 7	Segment 7 White	0-255	0

# Size and Weight

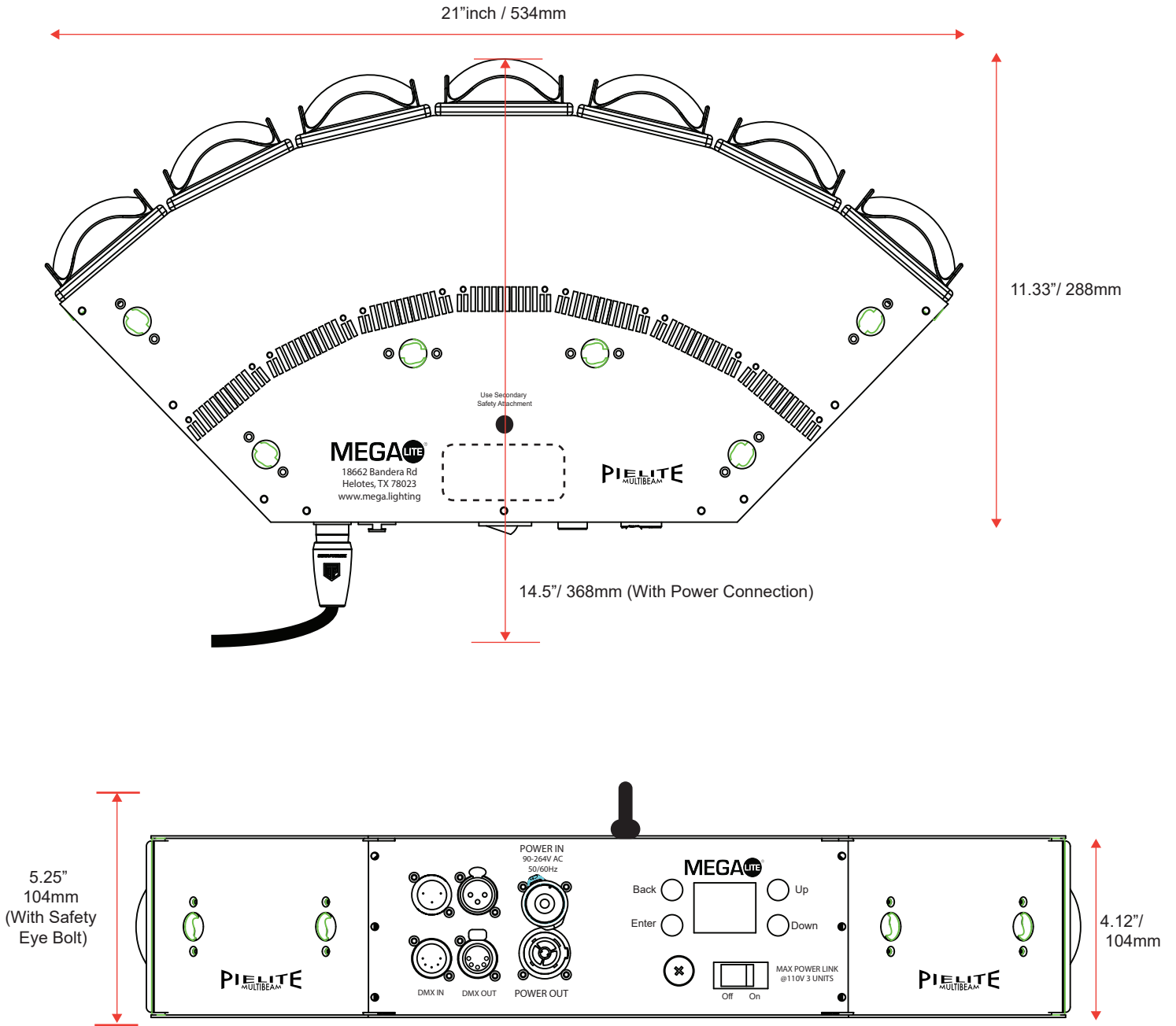

Fixture Size:	21" X 11.33" X 5.25"
Fixture Weight:	15lb 14oz
Packaged Size:	25" X 13.75" X 8"
Packaged Weight:	18lb

## Segment

---

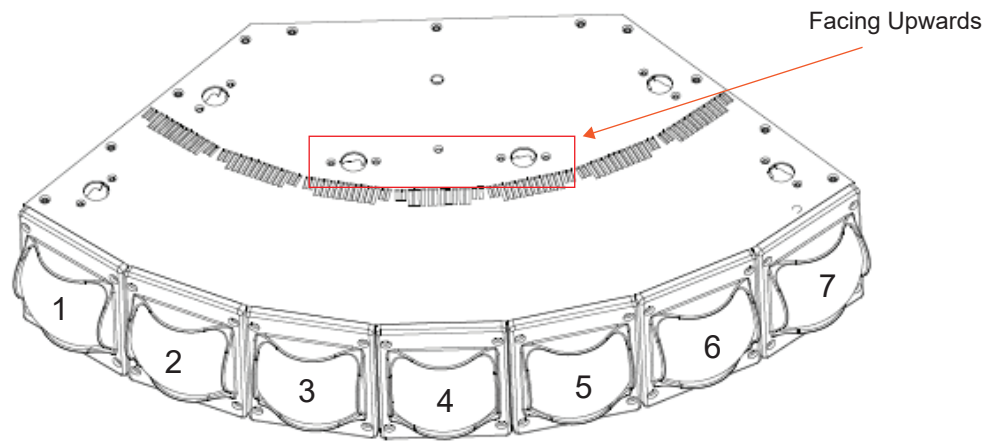

Segment Positions

## Installation

---

### Caution!

1. The Installation must be carried out by an authorized dealer or trained professional.
2. Unit may cause severe injuries, if you have doubts concerning the safety do not install.
3. Unit is to be 24 inches away from flammable materials.
4. Use high quality installation equipment to hang the unit.
5. Internal Fan Filters must be cleaned periodically as not to block airflow.

When rigging the it is very important that you follow common safety procedures. Rigging requires extensive experience including but not limited to calculating working weight loads, material being used and periodic safety inspections. If you lack these qualifications, do not attempt the installation yourself, instead use a professional structural rigger.

When rigging the unit always be secure with a secondary safety attachment. The installation location of the fixture has got to be built in the way that it can hold 10 times the weight for 1 hour with out any failures. Installation should be checked at least one time a year by a skilled professional.

# Fixture Hanging Orientations

Fixture can be hung in the following configurations with the included hardware.

## Vertical Pie



## Half Pie

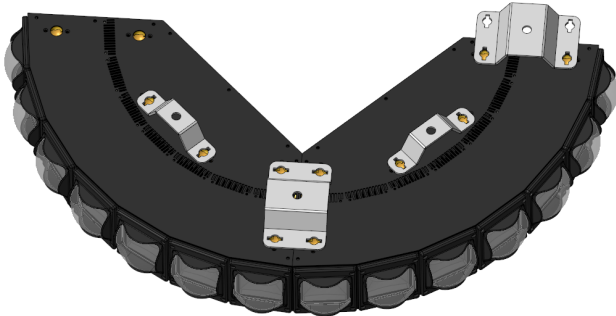

When Connecting 2 or more Pielite's together, make sure you are using the quick connection brackets on top and below the fixtures.

## Full Pie



## General Terms & Conditions

1. All resellers must have approved and signed Reseller Application on file, including their respective state tax information and W-9. Applications are re-evaluated on a fiscal calendar year basis to assure business integrity and tax status.
2. Cash, check, cashiers check, ACH, wire transfer, MasterCard, Visa, Discover, and American Express are accepted forms of payment.
3. Past due invoices will be charged 1.5% per month finance charge. Uncollected invoices are subject to be turned over to collection.
4. The reseller will pay all reasonable expenses incurred in the course of collections.
5. The proper venue for litigation will be Bexar County, Texas.
6. Returned checks will be charged a \$50.00 fee.
7. All prices are in U.S. Dollars.
8. All prices and specifications are subject to change without notice, sales order confirmations are emailed and will reflect correct pricing.
9. All terms are insured, monitored, analyzed and approved by Coface USA. Changes in credit line and approved terms can change without notice. Company authorization of credit is based on Coface approvals. Any conflicts or disagreements should be referred to: 650 College Rd East Suite 2005 Princeton, NJ 08540. 1-609-469-0400. E-mail: cofaceusa@coface.com
10. Returns are subject to 25% restocking charge plus any necessary charges for repair or re-packaging.

## Shipping Terms & Conditions

1. All orders are EXW San Antonio, TX (EXW means that a buyer/reseller incurs the risks for bringing the goods to their final destination) any deviation needs to be done in writing.
2. UPS ground shipping is the preferred shipping method. Requests for specific carriers may require use of the customer's account number and may incur an additional charge for handling.
3. Drop shipments are subject to all return charges at resellers expense. Drop shipments are not allowed outside of the territorial United States.
4. NO C.O.D. shipments allowed.
5. Returned and undelivered shipment charges are the buyer/resellers responsibility and will be billed to the buyer/reseller.
6. The freight carrier and Company shipping@mega.lighting should be notified upon receipt of damaged freight, discrepancies, or non-conformities within 24 hours. Company can assist in making claims with carriers or agents in the event of any loss or damage.
7. Upon acceptance in good order by Carrier from Company, the material becomes the property of the Reseller.

## Warranty and Service Procedures

1. All returns require an RMA# (Return Merchandise Authorization number) before returning goods for any reason. For a service or warranty RMA, please email service@mega.lighting or call (210)684-2600. For sales or demo returns, please contact sales@mega.lighting.
2. Case will be created and an RMA notice will be emailed. All units received must have the RMA # included with the unit as well as on the shipping label.
3. All shipping charges are the responsibility of the customer: MEGA Systems, Inc., Service, 18668 HWY 16 N., Helotes, TX 78023

## Warranty for Products Purchased Before 2021

Unless otherwise stated in writing, product is covered by a one year parts and labor limited warranty and is subject to same limitations listed under the limited warranty exclusions listed below.

## Warranty for Products Purchased After January 1, 2021

**MEGA SYSTEMS INC** ("MSI") hereby warrants to the original purchaser/owner (Customer"), MSI products to be free of manufacturing defects in material and workmanship, for the warranty periods as defined below from the original purchase invoice date. This warranty applies exclusively to new MSI branded and/or distributed products listed below, purchased from an MSI AUTHORIZED dealer/reseller. This warranty is not transferrable and may or may not apply to products sold and/or forwarded outside the United States. Please contact MSI for applicable regional product warranty information.

The purchase of MSI product constitutes the Customer's acceptance of all warranty terms and conditions as listed in this limited warranty statement. This warranty provides the Customer with legal rights, which may vary from state to state. Please contact MSI regarding warranty questions prior to purchasing.

Product / Series	Warranty Period	Coverage
Battery Powered LED	Six month battery, one year all other components	1, 2
Moving LED, Hazers	One Year	2
Outdoor IP-Rated LED	Two Years	3
House Light LED, Decorative LED, Compact LED, iCandy LED, Theatrical LED, Strobe Wash LED, Follow Spot LED, Production & House of Worship Control, Architectural Control, Theatrical Control, Dance Venue & Mobile DJ Control, Direct View LED Displays, and MV Controllers	Three Years	4

**1. Battery: 183 days/six months 2. Parts and Labor: 365 days/one year 3. Parts and Labor: 730 days/two years 4. Parts and Labor: 1095 days/three years**

### This limited warranty excludes any defects caused by, resulting from, or relating to the following:

- Normal wear and tear of lamps, color media, brushes, contact rings, lamp sockets, belts and other parts prone to wear and tear.
- Misuse, abuse, improper handling, accident, alteration or attempts to repair by or on behalf of the owner or any person not authorized by MSI.
- Damage to the product resulting from acts of God, including but not limited to, earthquakes, hurricanes, tornadoes, lightning and other natural disasters, fire, explosion, flood, riots, civil disorder or any other cause beyond the reasonable control of MSI.
- Exposure to harsh or excessively corrosive environmental conditions (whether indoors or outdoors) including, but not limited to, extreme temperature, humidity, atmospheric conditions (including salinity or pressure), radiation (UV, infrared or nuclear), shock and conditions which exceed the product's Ingress Protection ("IP") rating.
- Use of the product in a manner which exceeds the applicable product specification, including, but not limited to, exposure to excessive, insufficient, or other voltage conditions.
- Installation or use of the product not in accordance with the technical documentation, MSI guidelines (as may be posted on its website at www.megasystemsinc.com from time to time or otherwise designated by MSI or its brands) or applicable building and electrical codes, regulations, and standards.
- Failure to maintain the product in accordance with the technical documentation.
- Natural degradation and color shift of the LED source over the course of normal product use.
- Slight deviations in the specified values of intensity and color that do not affect the functionality of the product.
- Use of the product not for its intended purpose.

All warranty claims are evaluated under the terms of this limited warranty. If a product falls within the warranty period and if, upon examination by MSI, it is found to have failed for a covered cause, MSI will, at its sole discretion, repair or replace the defective part or product or reimburse the purchaser a pro-rated portion of the purchase price based on the percentage of the warranty period still remaining as of the date that the returned product was received by MSI. Should a replacement part or product be discontinued or unavailable, MSI reserves the right, in its sole and absolute discretion, to substitute a comparable replacement part or product for the defective part of product. MSI warranty obligation herunder is limited solely to the repair or replacement of or reimbursement for the particular parts or products determined by MSI to have failed for a covered cause within the warranty period. In no event shall MSI be responsible to replace or reimburse purchaser for any products or portions of a system that MSI determines has not failed for a covered cause within the warranty period, even if such other products or portions of a system are used together with products being repaired or replaced by MSI under this warranty and the repaired product differs in brightness, colors or any other attribute after the repair.

Costs of removal, shipping to MSI or its authorized representative and reinstallation are solely the responsibility of the purchaser. If MSI determines that the product is covered by this limited warranty, it will only pay for parts and labor as indicated by product type. If MSI determines that the product is not covered by this limited warranty, the purchaser will have the option of paying for the repair if the product can be repaired and the purchaser shall be responsible for the cost of shipping the repaired product back to the purchaser. MSI reserves the right, in its sole and absolute discretion, to decline any repair.

IN NO EVENT SHALL MEGA SYSTEMS, INC. BE LIABLE FOR ANY INCIDENTAL, CONSEQUENTIAL, SPECIAL, INDIRECT OR PUNITIVE LOSS OR DAMAGE OF ANY KIND, INCLUDING, BUT NOT LIMITED TO, LOSS OF PROFITS OR REVENUES, LOSS OF USE OF THE PRODUCT OR ANY OTHER GOODS OR ASSOCIATED EQUIPMENT, DAMAGE TO ANY ASSOCIATED EQUIPMENT, COST OF CAPITAL, COST OF SUBSTITUTE PRODUCTS, FACILITIES OR SERVICES, DOWN TIME COST, INSTALLATION OR LABOR COSTS, OR CLAIMS OF THE PURCHASER'S CUSTOMERS, WHETHER BASED ON WARRANTY, CONTRACT OR NEGLIGENCE, ARISING IN CONNECTION WITH THE SALE, USE OR REPAIR OF THE PRODUCT. MEGA SYSTEMS INC'S MAXIMUM LIABILITY SHALL NOT, IN ANY CASE, EXCEED THE PURCHASE PRICE OF THE PRODUCT THAT GIVES RISE TO THE CLAIM.

EXCEPT FOR THE LIMITED WARRANTY SET FORTH HEREIN, ALL PRODUCTS SOLD BY MEGA SYSTEMS, INC. ARE SOLD "AS IS" WITHOUT ANY WARRANTY, EXPRESS, OR IMPLIED, STATUTORY OR OTHERWISE, INCLUDING, BUT NOT LIMITED TO, IMPLIED WARRANTIES OR MERCHANTABILITY AND FITNESS FOR A PARTICULAR PURPOSE, ALL OF WHICH ARE EXPRESSLY AND SPECIFICALLY DISCLAIMED BY MEGA SYSTEMS, INC.

## Customer Support

---

MEGA-Lite has a customer support line to provide set-up help and to answer any questions should you encounter a problem. Please visit our website for any other related technical documents. For service related issues, please contact our service dept.

Monday - Friday 9am to 6pm CST  
(210)684-2600  
Service@mega.lighting

## Manual Version

---

Please visit [www.mega.lighting](http://www.mega.lighting) for the most up-to-date manual version.

Manual Version	Date	Fixture Software	Notes
1.0	01/15/2025	1.0.0	



MEGA LITE  
18662 Bandera Rd  
Helotes, TX 78023  
Phone (210)684-2600 / Fax (210)855-6279  
[www.mega.lighting](http://www.mega.lighting) / [info@mega.lighting](mailto:info@mega.lighting)